

SERVICE INFORMATION

Number: 811-1696 UTG. 2

Year: 1996

Month: NOVEMBER

Market: ALL

Top cover

To remove



There is always a danger of injuries caused by crushing when work of any kind is carried out on the hood.

- 1 Operate the hood to the halfway open position.
- 2 Remove the headlining. See "Headlining".
- 3 Remove the retaining strip.

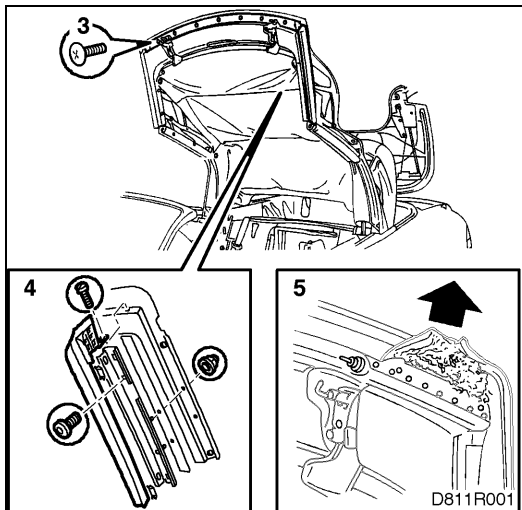

- 4 Remove the front rail seals and seal holders.
- 5 Detach the hood fabric from the first bow.

- 6 Drill out the pop rivets securing the wires in the hood fabric.

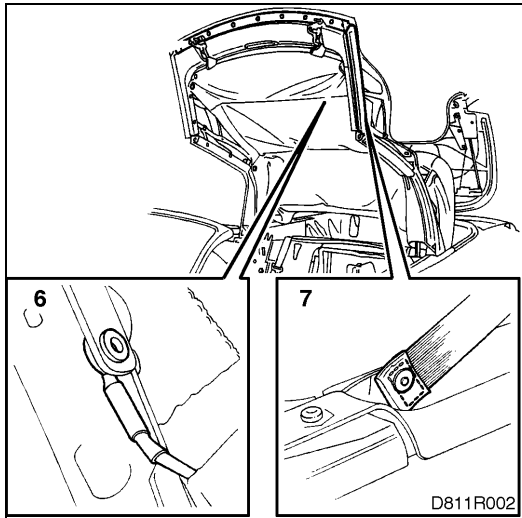

- 7 Drill out the pop rivets securing the front side elastic straps to the front rails.

- 8 Detach the top cover from the second bow.

- 9 Drill out the pop rivets securing the rear side elastic straps to the middle rails.

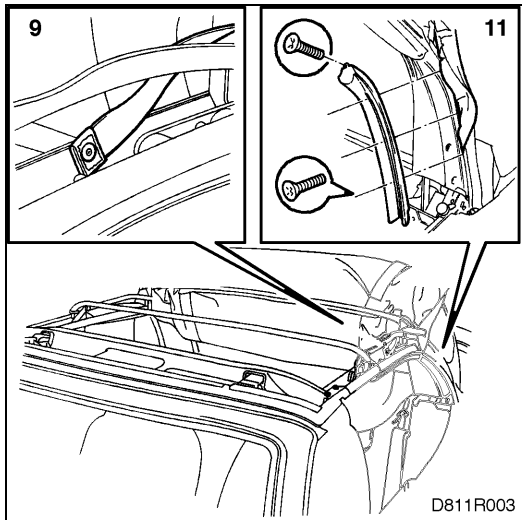

- 10 Detach the top cover from the third bow.

- 11 Remove the rear rail seals.

12 Remove the covers below the rear rails.

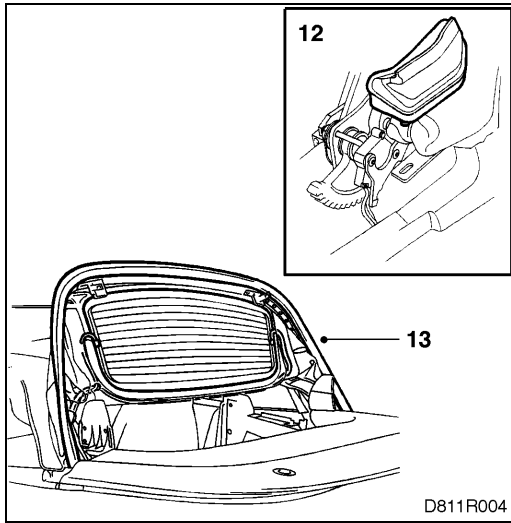

13 Remove the fifth bow's seal.

14 Detach the hood fabric from the fifth bow.

15 Raise the hood mechanism fully.

- 16 Lift up the rear window by hand, unplug the connectors for the rear window electric heating element and withdraw the leads from the hood fabric.

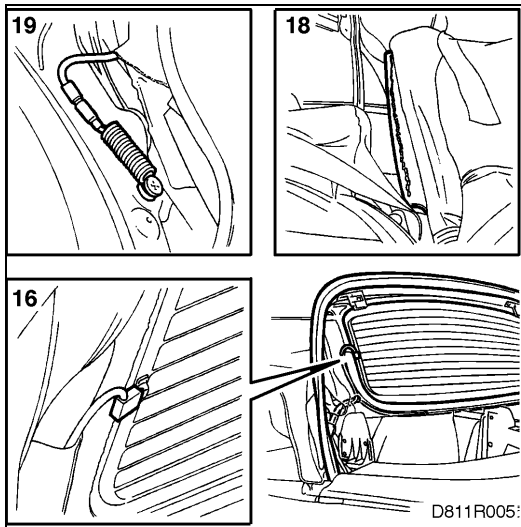

- 17 Remove the felt strip covering the staples in the fourth bow.
- 18 Mark the centre of the fourth bow and on that part of the hood fabric which is stapled to the fourth bow. Then remove the staples.
- 19 Withdraw the wires from the sides of the hood fabric.
- 20 Lift the hood fabric away.

To fit

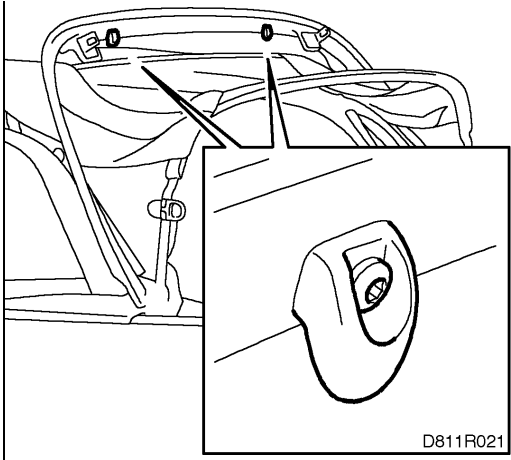

WARNING

There is always a danger of injuries caused by crushing when work of any kind is carried out on the hood.

The following method describes how to fit a top cover incorporating a rear window mounted with clips. If a top cover with glued rear window is to be fitted, follow the directions in Service Manual 8:5 "Cabriolet".

IMPORTANT

Check whether the fifth bow has guides for the rear window. If these are missing, points 1-13 must first be carried out before the hood fabric is fitted.

- 1 Detach the guide in the middle of the fifth bow and remove all surplus adhesive.

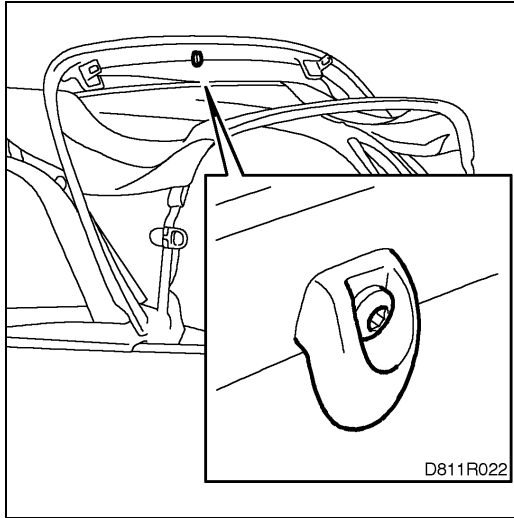

- 2 Make marks 30 cm from the centre point where the rear window guides on the fifth bow are to be fitted.

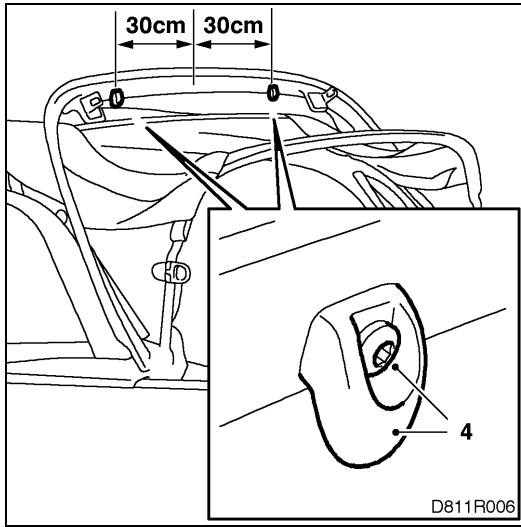

- 3 Drill two 5.0 mm holes at the marks. Cut threads in the holes using an M6 tap. Deburr the holes at the rear.

IMPORTANT

The holes must be carefully deburred as the hood fabric will otherwise be damaged with leakage as a result.

- 4 Apply threadlocking adhesive to the screws and screw the guides in place on the fifth bow.

IMPORTANT

Check that the tip of the screw does not protrude at the rear. If it does, the protruding part must be filed down.

- 5 Drill out the pop rivets in the existing stop plates on the fourth bow and remove same.

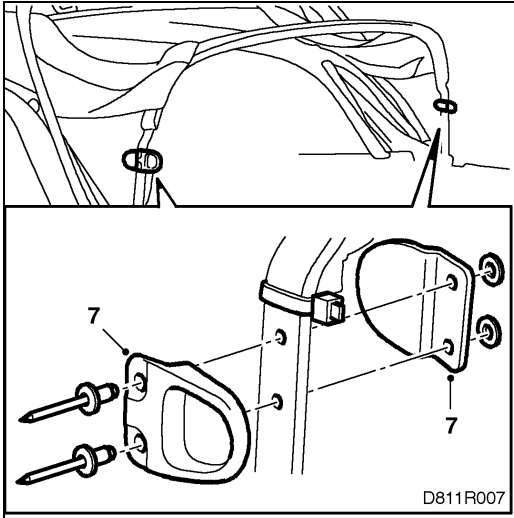

- 6 Enlarge the holes in the fourth bow and the new stop plates to a diameter of 5.0 mm. Deburr the holes.
- 7 Secure the stop plates with pop rivets, as shown. Fasten the wiring harness on the left-hand side with a cable tie.

- 8 Remove the lower screws from the toothed segment's link for the fifth bow.

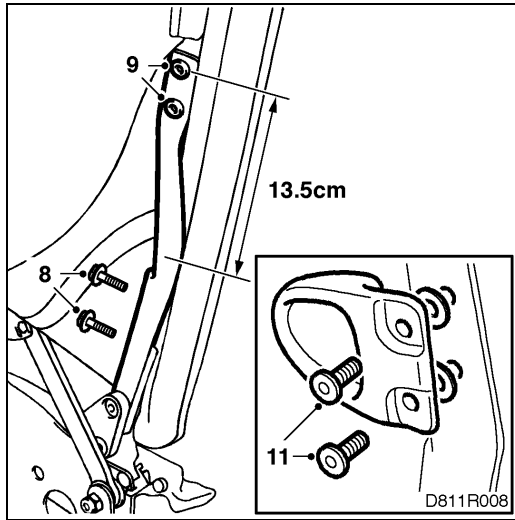

- 9 Back off the two upper screws a few turns and insert a screwdriver between the fifth bow and the link so that it bends outwards.
- 10 Mark the position of the stop plate's lower retaining hole by measuring 135 mm from the centre of the upper screw. Then use the stop plate as a template for the upper retaining hole. Drill the holes, using a 3.5 mm bit.
- 11 Screw the stop plates in position as shown.
- 12 Apply threadlocking adhesive to the screws securing the link to the fifth bow and tighten them.
- 13 Use a vacuum cleaner to remove all drillings, etc. from the interior of the car.

14 Adjust the fourth bow down to its lowest position.

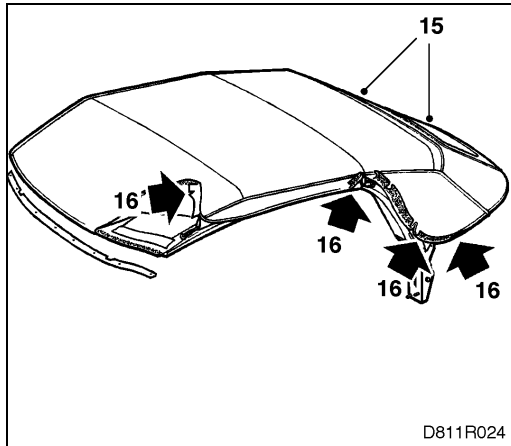

15 Place the top cover in position on the hood frame. Make sure that the hood fabric fits round the fifth bow and round the rear rail's corners.

16 Make cuts in the cloth lip that is to be glued so that it fits better on the frame. Use the frame as a template and make the cuts as shown.

17 Glue the rear of the hood fabric to the fifth bow as described below. Use 3M Super Weatherstrip Adhesive.

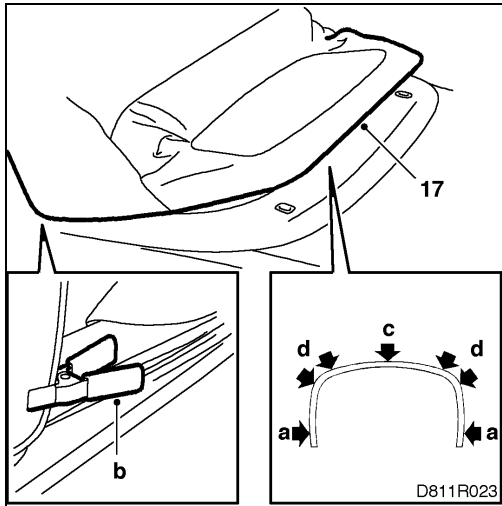

- a Start by gluing the hood fabric to the fifth bow's corners.
- b Secure the hood fabric to the corners of the hood frame's rear rails before the adhesive on the fifth bow's corners has had time to dry. Use a clamp to hold the fabric in place at the corners. Otherwise the hood fabric might end up crooked.
- c Then glue the hood fabric to the middle of the fifth bow.
- d Finally, glue the remainder of the rear end of the hood fabric to the fifth bow.

18 Insert the wiring for the rear window heating element through the hood fabric and plug in the connectors.

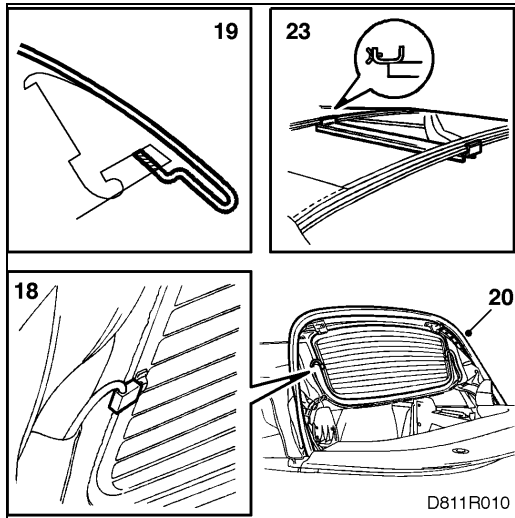

19 Cut away surplus fabric round the fifth bow. Cut on the inside of the sealing strip's outer flange so that spilt glue can be concealed by the sealing strip. Use a razor blade or carpet knife. Make sure that the flange for the sealing strip is visible.

20 Press the sealing strip into place on the fifth bow. Use a soap solution on the seal to facilitate fitting it. Remove the clamps.

21 Raise the hood fully so that the fifth bow is locked in place.

22 Fold the top cover rearwards.

23 Secure the fourth bow to the third bow, using special tool 82 93 045.

IMPORTANT

It is absolutely necessary to secure the fourth bow immovably so that it will not be displaced when the top cover is fitted.

- 24 Pull the top cover's fabric lip over the fourth bow and centre it according to the marking. On new top covers the centre is marked by a notch cut into the fabric. Tauten the fabric lip firmly and staple it in place.

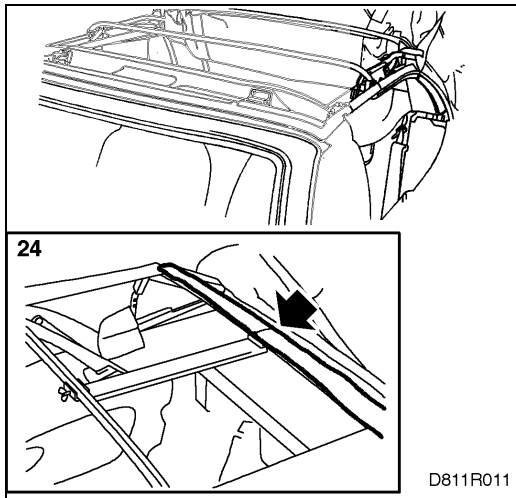

- 25 Fit the felt strip in place over the fourth bow.

- 26 Fold the hood fabric forwards and glue it to the hood frame's rear rails. Use 3M Super Weatherstrip Adhesive. Hold the hood fabric in place at the corners with clamps. Allow the adhesive to dry and then remove the clamps.

- 27 Fit the covers under the rear rails in place and tighten the nuts.

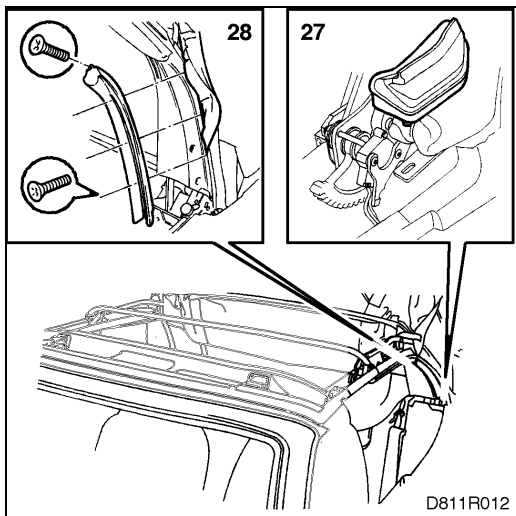

- 28 Refit the seals on the rear rails. Cut off any surplus fabric.

29 Pull the wires out through the sides of the hood fabric.

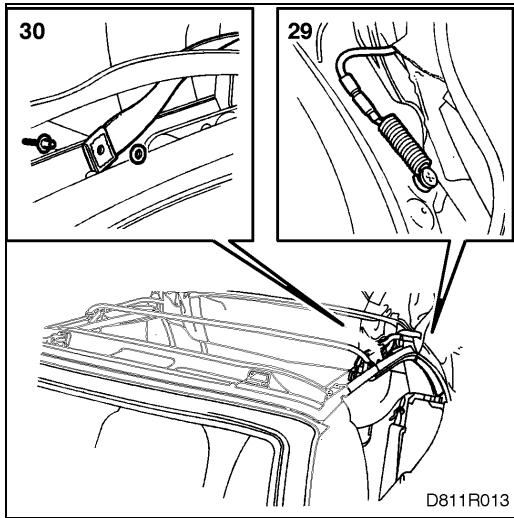

30 Pop rivet the rear side elastic straps to the hood frame's centre rails.

IMPORTANT

The elastic strap should be pulled over the linkage.

31 Pop rivet the wires in place, flat side outwards.

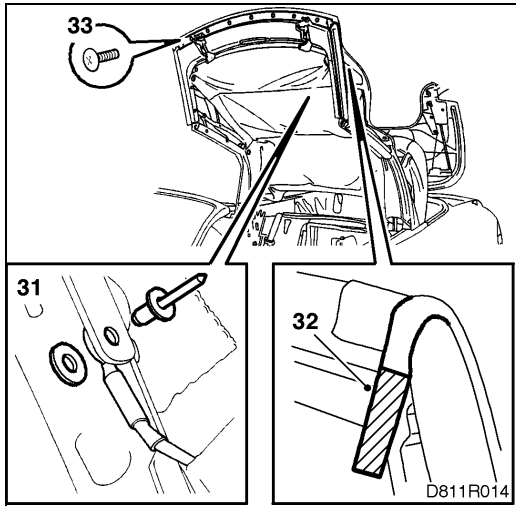

32 Glue the top cover to the first bow. Start at the corners. Apply adhesive to the lip and fold it down. Cut off the lip's surplus fabric, as shown. Use 3M Super Weatherstrip Adhesive.

33 Screw the retaining strip to the first bow.

34 Rivet the front side elastic straps to the hood frame's front rails. Use blind rivets. Do this in the same way as for the rear rails, see point 30.

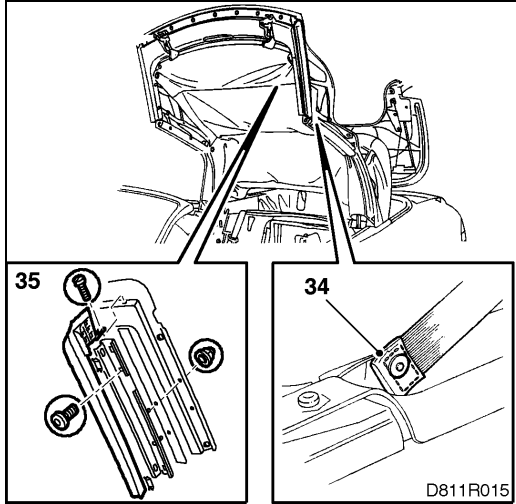

35 Refit the front rail seal holders and seals.

36 Secure the top cover to the third and second bows.

37 Check the fit of windows and seals. It might be necessary to adjust the fourth bow upwards so that the door windows clear the hood fabric when the doors are opened and closed.

- 38 Adjust the seals as necessary. See the "Adjustment" section in Service Manual 8:5 "Cabriolet".
- 39 Refit the headlining. See "Headlining".
- 40 Connect an ISAT scan tool, clear any diagnostic trouble codes and then program the control module. See "Programming control modules" in the "Fault diagnosis" section of Service Manual 8:5 "Cabriolet".
- 41 Check for leakage by hosing the hood with water obliquely from above.
Never use a high-pressure water supply.