

SERVICE INFORMATION

Number: 811-1711

Year: 1997

Month: FEBRUARY

Market: ALL

Poor adhesion between rear screen and top fabric

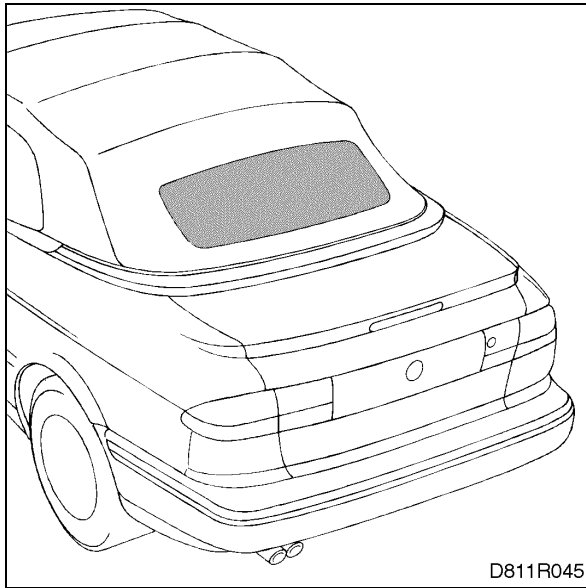

Cars affected

Saab 900 Convertible, M95 onwards with early-version top frame and bonded rear screen.

Background

On certain cars, the rear screen and the top fabric can become partially unglued, giving rise to wind noise and leakage.

A new adhesive kit has been produced to rectify the problem. Follow the procedure described below.

Parts required

Adhesive kit: (16) 30 30 699 (CA: 30567749)

Inspection

Check the adhesion between the top fabric and the rear screen both on the inside and the outside. If the adhesion is poor all round the screen or on more than two sides, we recommend replacement of the top fabric.

It is only poor adhesion between the rear screen and the PVC strip that can be rectified. If the bond between the PVC strip and the top fabric is poor, the top must be replaced.

Procedure

Choose a suitable position for the fifth bow, depending on whether the work is to be done on the inside or the outside of the glass. In the following example, the repair will be made to the edge outside.

NOTE

Lower at least one of the windows so that, if doors are opened and closed after the rear screen has been glued, the change in air pressure will not affect the glue as it is drying.

- 1 Cover over the glass from the edge of the original glue.

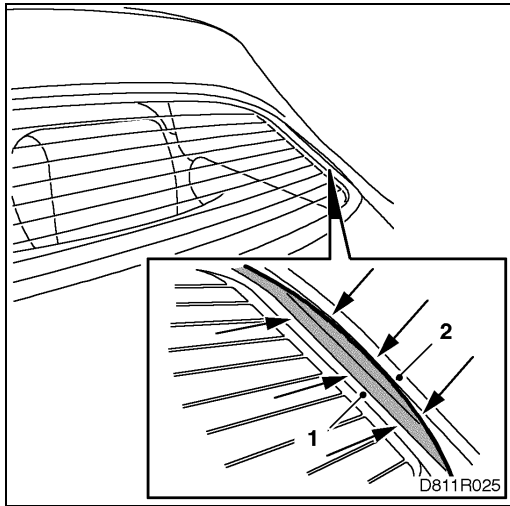

- 2 Apply masking tape from the edge of the underside of the PVC strip on the top fabric and round the edge of the top fabric.
- 3 Thoroughly clean the surface to be treated.
- 4 Wipe glass activator over the glass and the PVC strip on the top fabric.
- 5 Wipe dry using the lint-free cloth supplied with the kit. Take care not to touch the surface after you have cleaned it.

IMPORTANT

Do not leave the glass activator to dry naturally, as this will leave grease on the surface. Always wipe it off with a clean, lint-free cloth, refolding the cloth frequently.

- 6 Apply glass primer to the PVC strip and the glass, and leave it to dry for at least five minutes.

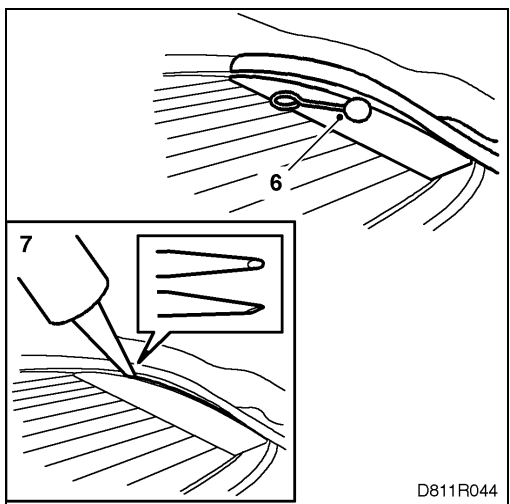

- 7 Snip off the end of the nozzle (as shown) and apply a thin, even string of glue to the primed surface of the glass.
- 8 Press the glass and fabric together by hand, taking care to smooth out any lumps or ridges. The edge of the fabric can be taped to the glass.
- 9 Operate the ROOF button to move the fifth bow to the locked position, and then latch the front bow to the windscreen frame.
- 10 Leave the glue to dry for at least 16 hours.

IMPORTANT

The drying time for the glue is 16 hours at a temperature of 20°C and a relative humidity of 50%. If the glue is to make a firm bond, the car must not be moved or disturbed in any way. Do not close any doors, the trunk (boot) or hood (bonnet), nor rock or roll the vehicle.

Do not raise or lower the top whilst the glue is drying.

- 11 Remove any tape and use a razor blade to trim off any surplus glue.

Standard-time information

Object code: 84353

Diagnostic trouble code: 35

Location code: 09

Action code: 05

Time: 1.0

Warranty conditions

Standard warranty conditions apply.