

**SERVICE INFORMATION**

Bulletin Nbr: 811-2092

Date:.....May 1999

Market: all

**Noise from fifth bow lock mechanism**

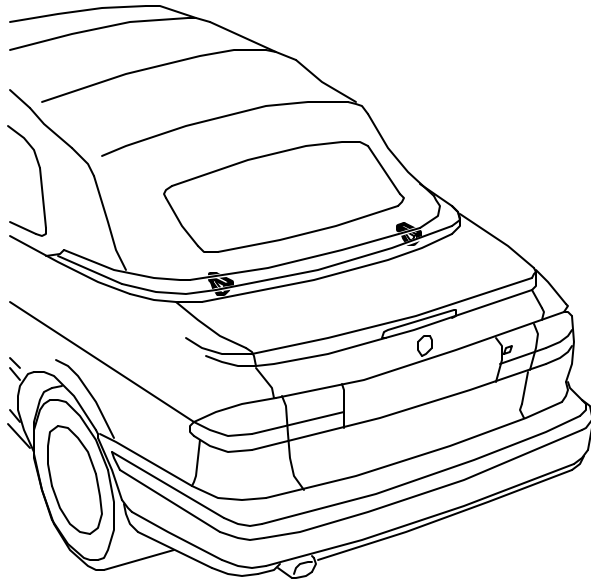

D8118091

**Cars concerned**

Saab 9-3 Convertible M98-M99 up to and incl. chassis no. X7055939

**Background**

On certain cars, noise can be heard from the fifth bow lock mechanism. The noise is caused when the lock engages or unlocks due to the lock fitting pushing on the lock mechanism. The following should be performed in case of customer complaints.

**Materials**

48 55 714 Lock fitting, left (CA: 30575675)

48 55 722 Lock fitting, right (CA: 30575674)

51 82 712 Fifth bow lock, left (CA: 30582860)

51 82 720 Fifth bow lock, right (CA: 30582861)

**Diagnostic procedure**

### Changing fifth bow lock fitting

1. Run the soft top so that it is raised (closed) and the fifth bow stands straight up.

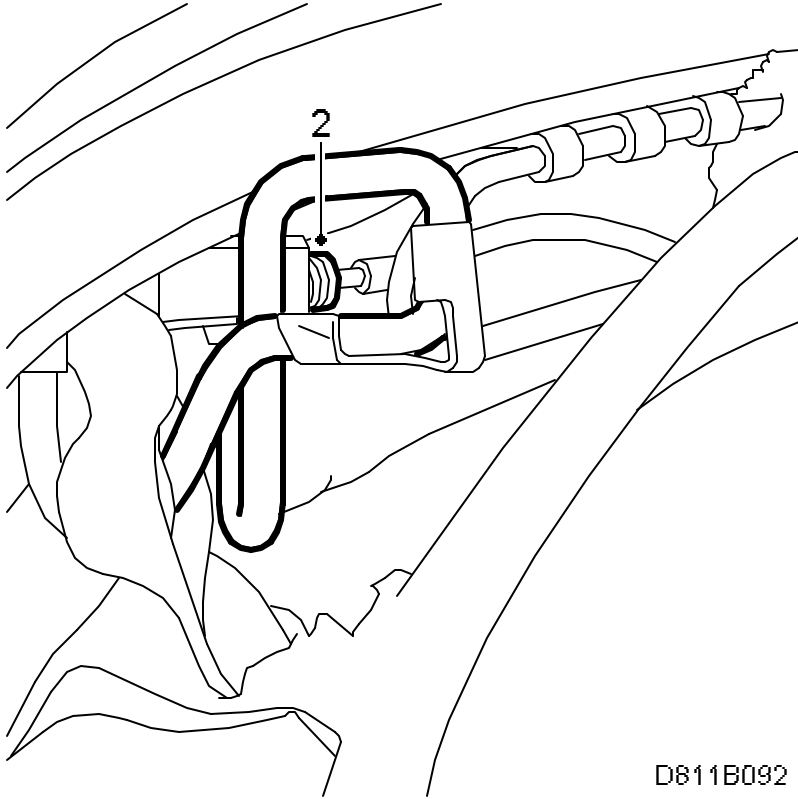

D811B092

2. Remove respective screw and change the lock fittings on the fifth bow.
3. Lower the fifth bow and check the lock fitting position in the lock for the soft top cover. The lock fittings should strike near the front edge of the holes in the soft top cover.

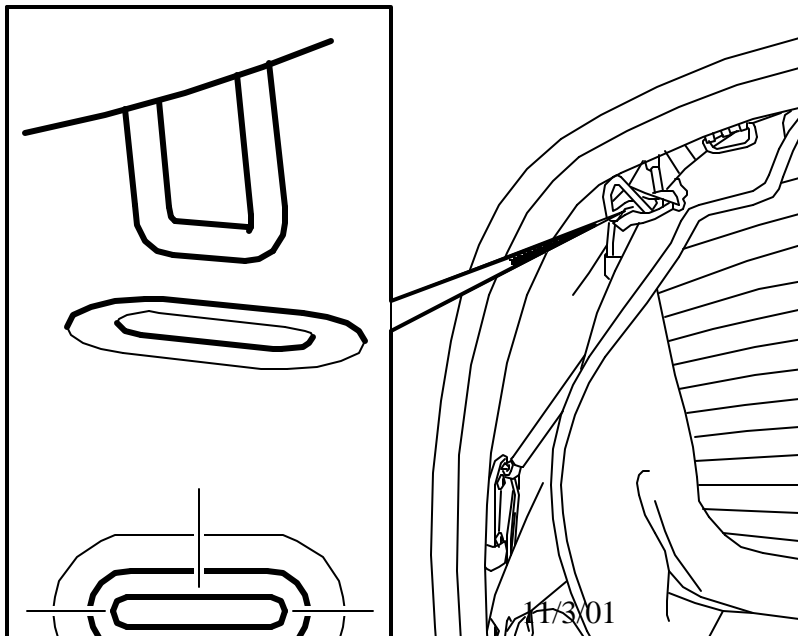

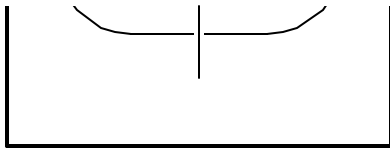

D811B093

4. If the lock fittings need adjusting, proceed as follows.

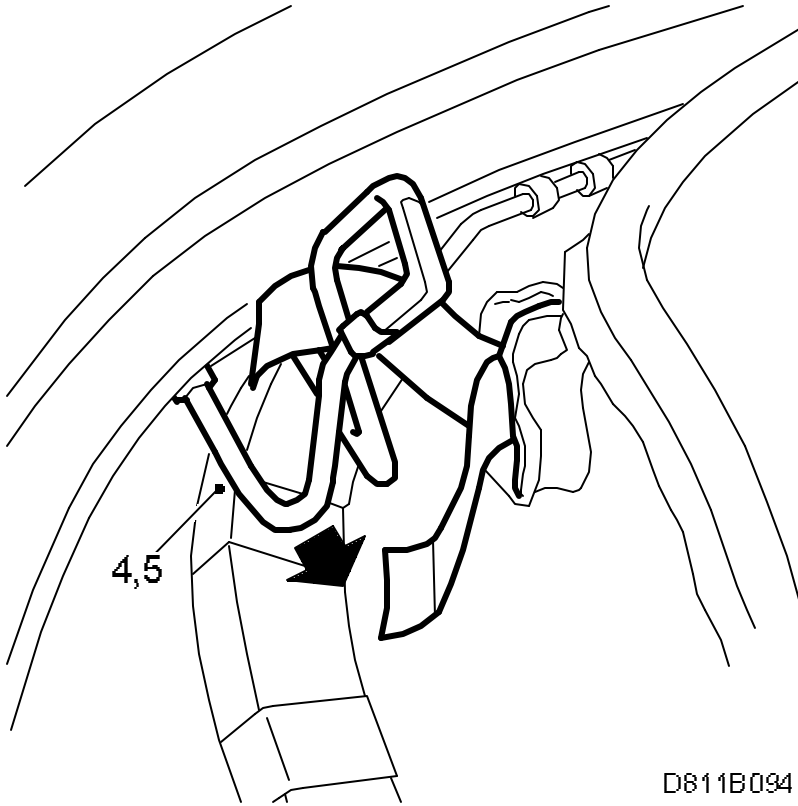

4.a. Raise the fifth bow.

4.b. Loosen the screw slightly and adjust the lock fittings by tapping them fore-aft so that they strike exactly in front of the elements in the locks.

5. Tighten the screw and lower the fifth bow. Check that the lock fittings strike directly in front of the lock elements in the locks.

### Changing fifth bow lock

1. Run the soft top so that the fifth bow and the soft top cover are completely raised.

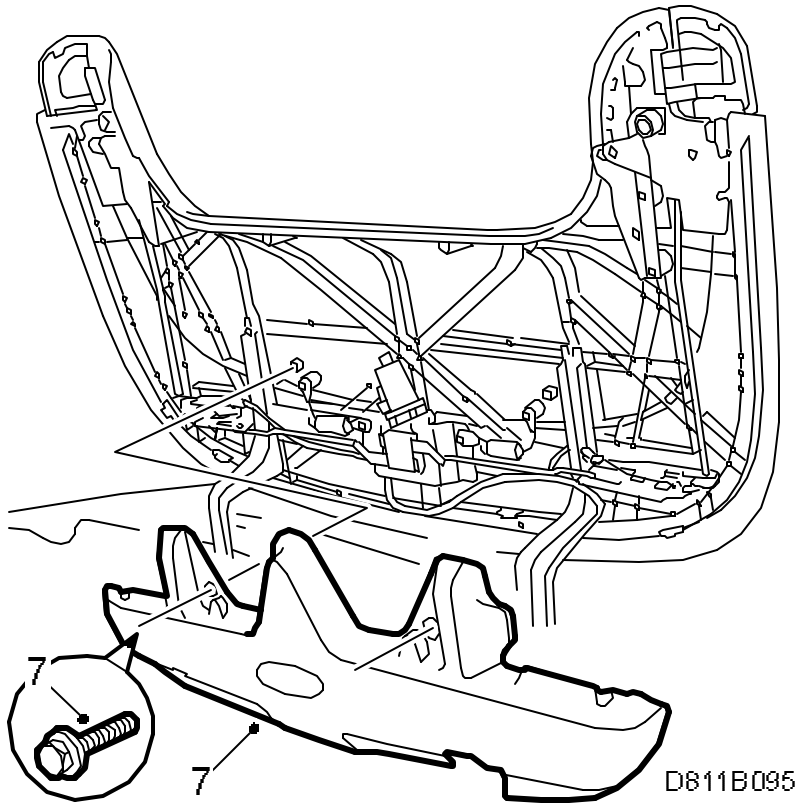

2. Remove the covering shell.
3. Connect the diagnostics tool and operate the fifth bow latch motor to half open position (soft top cover access flap is half open) using the command:  
"STC"  
"Activate"  
"Relay, fifth bow latch motor"  
"Up"
4. Protect the rear wings and the tailgate with wing covers. Insert the wing cover under the soft top cover, the motor can easily fall on the tailgate.
5. Remove the lock washers and the clips on the control rods. Disconnect the control rods from the fifth bow lock motor.

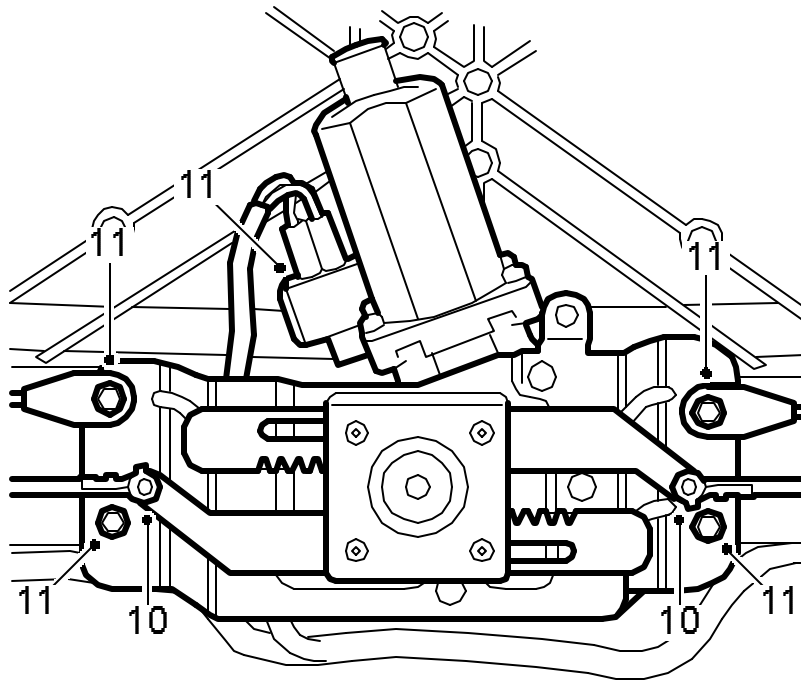

D811B096

6. Unplug the connector and remove the motor, hold a hand under the motor when the last screw is removed. Lift away the motor.
7. Remove the screws holding the fifth bow lock and let the operating arm for the turnable covers hang by the cable.
8. Fit the new control rods from the locks on the motor. Push the rods, from the rear, into the rack gears for the motor.

**Note**

No clips are needed.

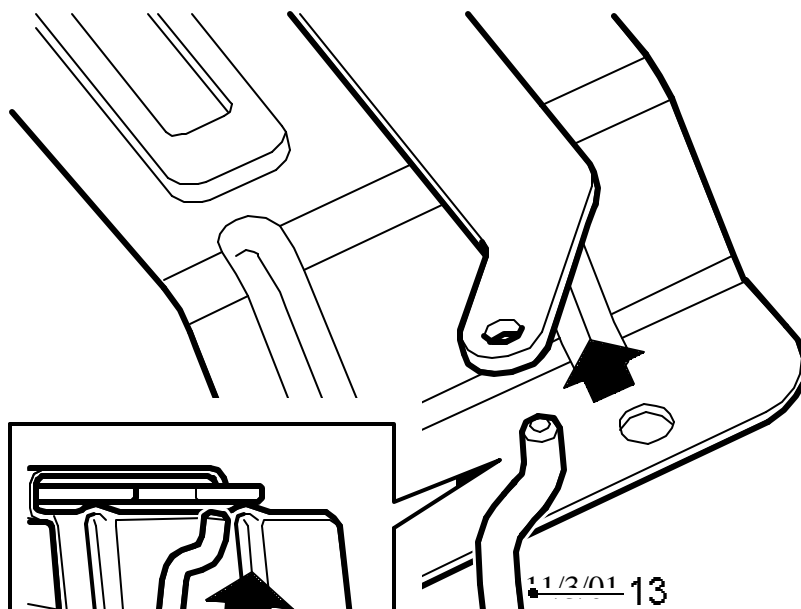

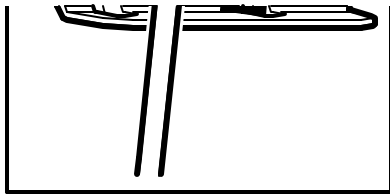

D811B097

- 9. With assistance from a co-worker, fit the lock motor and the two locks for the fifth bow. Hold the fifth bow lock against the soft top cover and fit the screws for the lock motor loosely. The impact cables end sleeves must be directed towards each other.
- 10. Begin by fitting the left lock for the fifth bow.

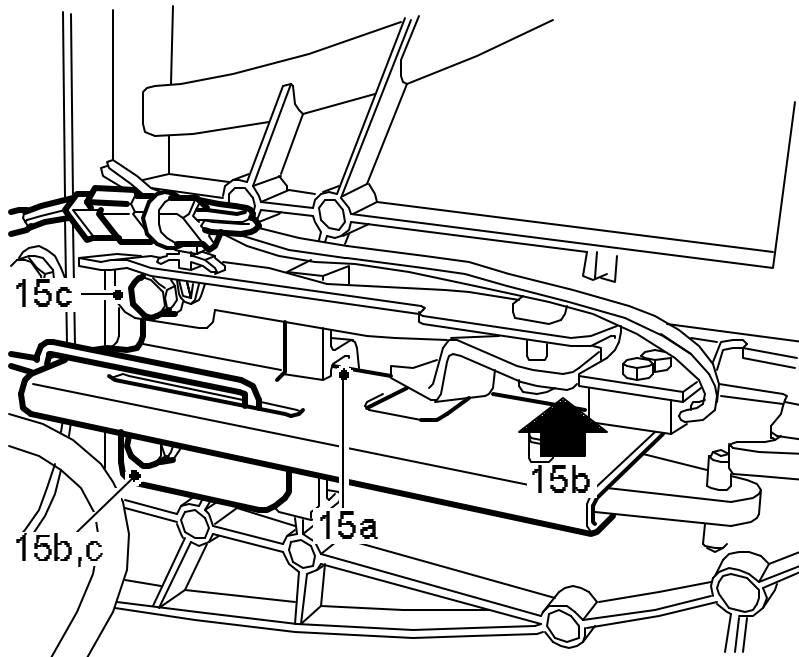

D811B099

- 10.a. Fit the lock into position and push the hook into the reinforcement member.
- 10.b. Tighten the lower screw and make sure that the guide ends up in the groove on the lock.

10.c. Tighten the lower and the upper bolt.

---

**Important**

Check that the lever for the microswitch moves easily.

---

Then fit the right lock for the fifth bow in the same manner.

11. Tighten down the lock motor and make sure that respective impact cable end sleeves are directed towards each other.

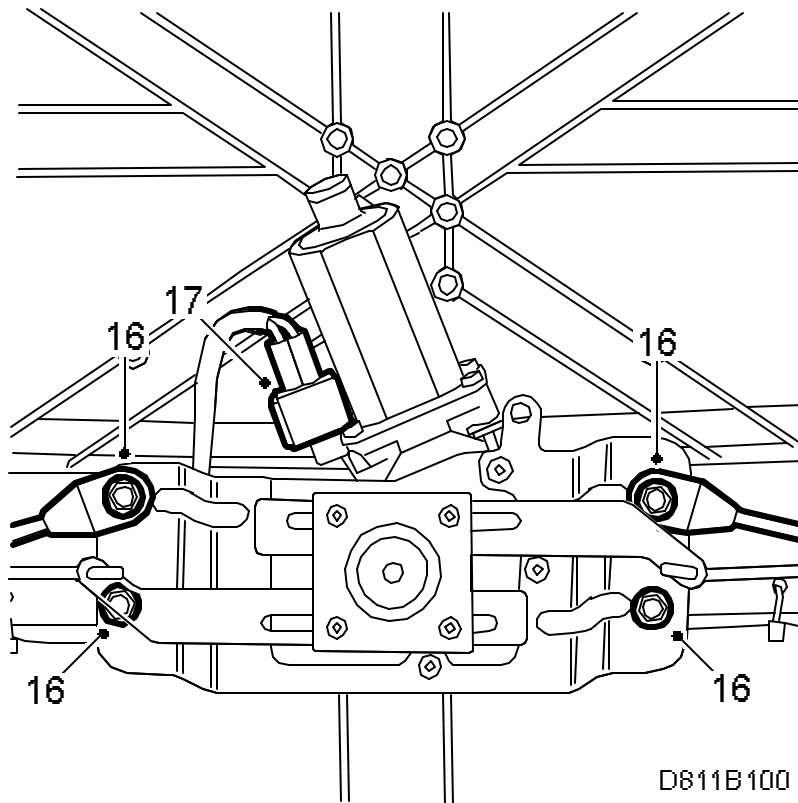

**Tightening torques:**

**Impact cable attachment: 14 Nm (10.3 lbf ft)**

**Motor attachment: 7 Nm (5.2 lbf ft)**

12. Plug in the connector.

13. Remove the cover from the tailgate, run the soft top up and down a few times and check the function.

14. Refit the shell.

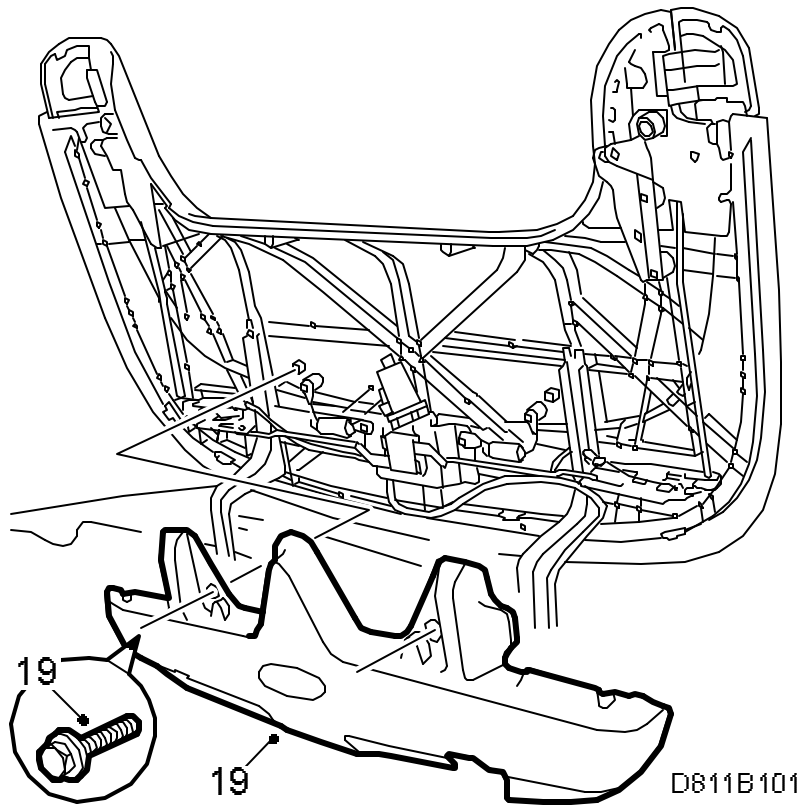

15. Adjust the lock function. See heading "Changing fifth bow lock motor".

16. Connect the diagnostics tool and erase any diagnostic trouble code.

17. Run the soft top to closed position and lock it to the windscreen frame.

#### Warranty/Time information

Failed Object: 81142, 81411

Fault/Reason code: 40

Location code: 09 (US = 3/4)

Warranty Type (US): 01

Repair/Action code: 01

Labour operation (US): 81142 x 2; (0.4) 81410 (0.9)

Time: (1.3 hours)

81142: 0.4 hours (CA: B2633)

81411: 0.9 hours (CA: B3357)

