

**SERVICE INFORMATION**

**Number:** 850-1749

**Year:** 1997

**Month:** MAY

**Market:** US

## Disconnection and reconnection of the passenger-side airbag

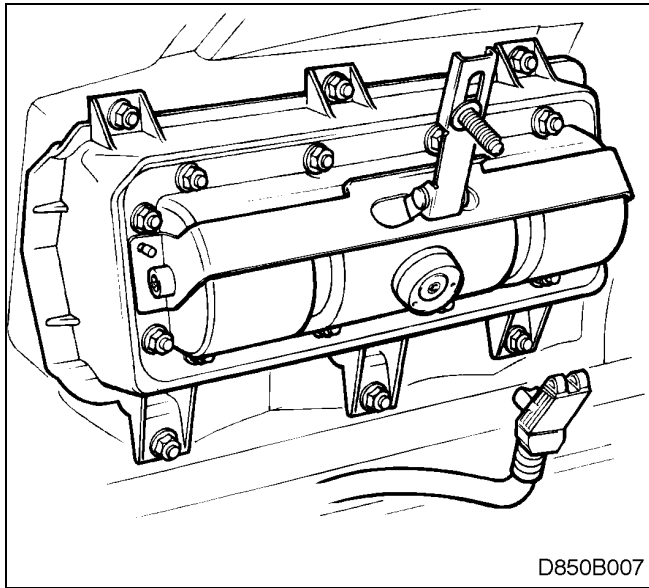

### Cars concerned

All M94-onwards Saab 900 cars equipped with passenger-side airbag

### Background

This SI describes the method of disconnection of the passenger side airbag recommended by Saab for those owners with written approval from the National Highway Traffic Safety Administration, US DOT. Saab has no role in the decision to undertake such a disconnection or any subsequent reconnection.

### Information/Parts Request Procedure

- The individual identified in the NHTSA approval must make a written request to Saab Cars USA, Inc. (Atten: Compliance) for this SI. The Vehicle Identification Number (VIN) of the applicable Saab automobile must be included.
- A copy of the written approval from NHTSA must be included with the above request.
- Saab will send this SI directly to the above individual.
- If the individual making the request wishes to use the following parts available from Saab through any authorized Saab dealer, the ordering dealer must include the VIN with the order.

### Parts Information

50 10 244 "Disconnection kit" (for 900 passenger-side airbag)

Contents:

Resistor

Fabric-backed tape

Cable tie

Label

Label ("WARNING: This airbag module may only be reconnected by authorized service personnel".)

### To disconnect the airbag

- 1 Disconnect the negative (-) battery lead.

- 2 Remove the glove box.
- 3 Unplug the passenger-side airbag connector.

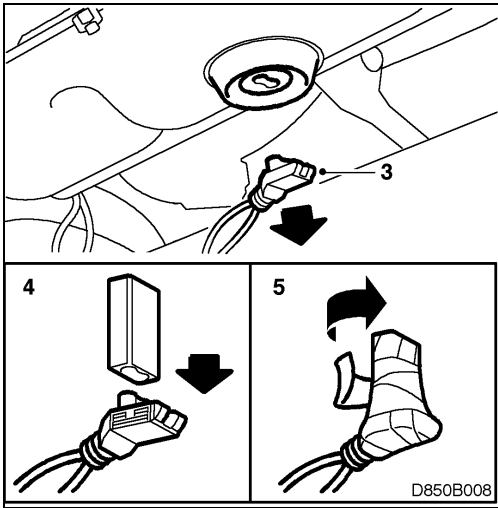

- 4 Fit resistor to the connector.
- 5 Wind at least three turns of the fabric tape round the connector and resistor.
- 6 Use a cable tie to secure the connector to the wiring loom above the steering column. Insert the cable tie between the column and the loom such that it will not give rise to rattling or squeaking.

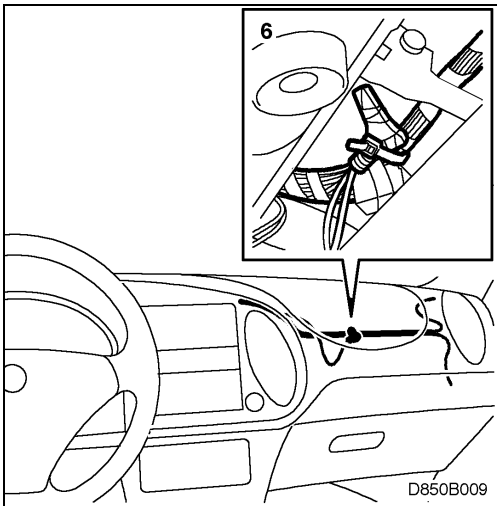

- 7 Affix label above the switch on the airbag module.

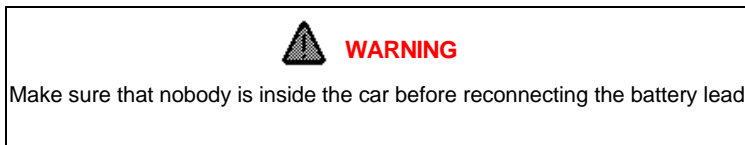
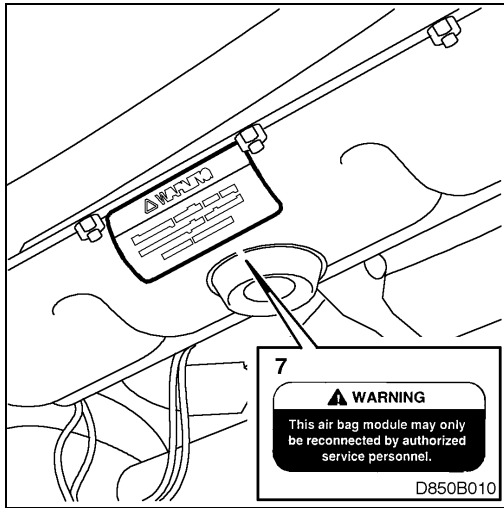

- 8 Reconnect the negative (-) battery lead.
- 9 Connect the ISAT scan tool and delete any diagnostic trouble codes (DTCs).
- 10 Switch on the ignition and wait at least 10 seconds. Check that the SRS symbol shows for 3 or 4 seconds and then goes out. Check that the SRS lamp is not indicating a fault (lamp remains on if fault detected).  
If a DTC is displayed, carry out the diagnosis procedure specified in Service Manual 8:6 SRS (Airbag).
- 11 Disconnect the ISAT scan tool.
- 12 Refit the glove box
- 13 Affix label to the panel as shown.

**To activate the airbag**

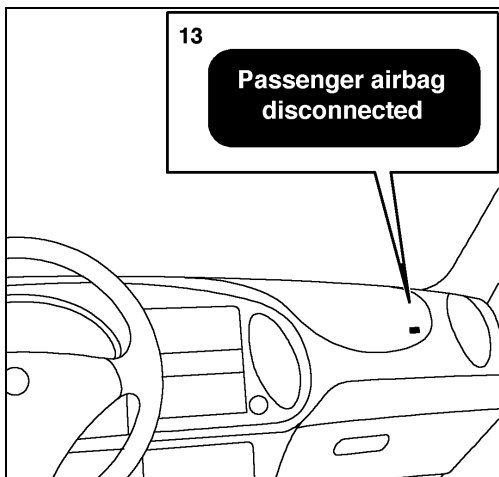

- 1 Disconnect the negative (-) battery lead.
- 2 Remove the glove box.
- 3 Snip off the cable tie securing the airbag connector to the wiring loom above the steering column.
- 4 Remove the warning label from the airbag module.
- 5 Remove the tape and the resistor from the connector.
- 6 Plug in the connector to the airbag module.
- 7 Refit the glove box.
- 8 Remove the warning label from the dash panel. Clean off any traces of adhesive: do not use solvents .



**WARNING**

Make sure that nobody is inside the car before reconnecting the battery lead.

- 9 Reconnect the negative (-) battery lead.
- 10 Connect the ISAT scan tool and delete any diagnostic trouble codes (DTCs).
- 11 Switch on the ignition and wait at least 10 seconds. Check that the SRS symbol shows for 3 or 4 seconds and then goes out. Check that the SRS lamp is not indicating a fault (lamp remains on if fault detected).
- 12 If a DTC is displayed, carry out the diagnosis procedure specified in Service Manual 8:6 SRS (Airbag).
- 13 Disconnect the ISAT scan tool.